



BAS 170

170 YEARS
OF THE
BUCKINGHAMSHIRE
ARCHAEOLOGICAL
SOCIETY



THE 170th ANNIVERSARY OF THE FOUNDING OF THE SOCIETY.

Many of you will have attended our initial celebration at the museum on the 9th December. Next, will be four public talks to which all are welcome, a series of press articles on Buckinghamshire's past - now underway - and some stalls at local markets currently being arranged.

BUCKINGHAMSHIRE'S SAXON PRINCE: THE BURIAL AT TAPLOW

HIGH WYCOMBE: Saturday 28th April 2018 at 2.30pm. Admission free.

Speaker: Leslie Webster, former Senior Keeper of the British Museum's Anglo-Saxon collections

The princely burial at Taplow was the most important burial of the Saxon period known in England before the discovery at Sutton Hoo. Leslie Webster, who formerly looked after the Taplow finds at the British Museum, will tell the story of their excavation and describe some more recent discoveries.

At 'The Sanctuary', Trinity United Reformed Church, London Road, High Wycombe, Bucks HP11 1BJ. **Admission free.** Organised jointly with the High Wycombe Society.



*The Burial Mound,
Taplow*



*Belt buckle of the
"Taplow Prince"*

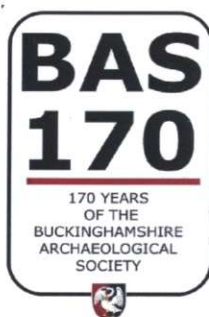

MISSENDEN ABBEY: ARCHITECTURE AND ARCHAEOLOGY

GREAT MISSENDEN: A Midsummer evening at the Abbey. Sunday 24th June 2018, 3.30pm. Talk, book launch, food, wine and tours of the abbey buildings and grounds. Tickets (all inclusive) £12, in advance from BAS 170, County Museum, and from Missenden Abbey Reception Desk. Tickets will be available from 23 April.

Speakers: Dr Jill Franklin, national expert on the Augustinians and Dr Yvonne Edwards, co-author of the Missenden Abbey Archaeology Report (copies available on the day).

Missenden Abbey, founded in 1133, was one of five Augustinian houses in Buckinghamshire. Although mostly demolished in 1538 part survived as a house, only to be damaged by fire in 1985. Dr Franklin will set the abbey in its medieval context. Dr Edwards will describe its archaeology.



Mediaeval Tile from Missenden Abbey

Tickets (all inclusive) £12, in advance from BAS 170, County Museum, and from Missenden Abbey Reception Desk. Tickets available from 23 April. Organised jointly with the Chess Valley Archaeological and Historical Society and Missenden Abbey Trust.



Trace of HS2 through Bucks

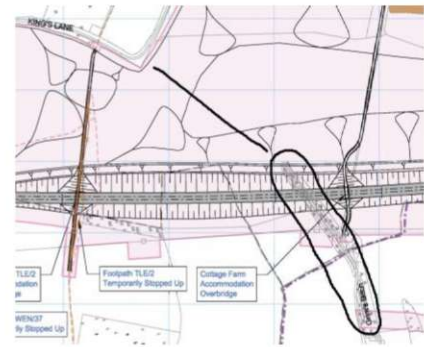
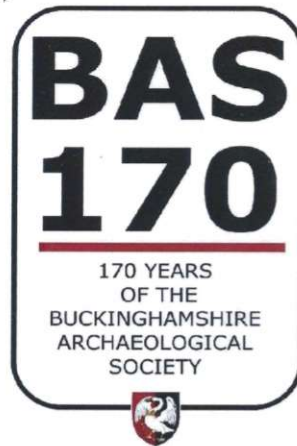

HS2 plan showing line crossing Grims ditc

UNCOVERING THE BURIED PAST BENEATH THE HS2 RAILWAY LINE THE BUCKINGHAMSHIRE LOCAL HISTORY NETWORK

Saturday 29 September 2018

Prehistoric boundaries,
a Roman town, a deserted medieval village, a ruined church and an
ancient burial ground...

This will be a full day of first-hand accounts from the archaeologists
carrying out excavations ahead of the construction of the HS2 high-
speed rail line across Buckinghamshire.

**At The Oculus, Aylesbury Vale District Council, Gatehouse
Road, Aylesbury**

Tickets £15 without lunch (full-time students under 25 free), £20 with
buffet lunch,

by post from BAS, County Museum, Church Street, Aylesbury HP20
2QP

(please make cheques payable to 'Bucks Archaeological Society').

A BUCKS LOCAL HISTORY NETWORK DAY
with displays by local societies

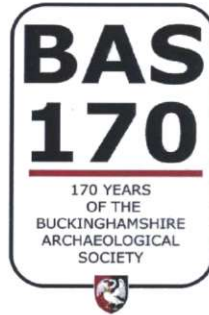
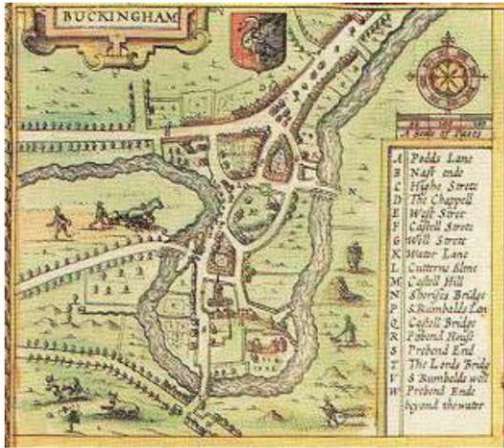

THE EVOLUTION OF BUCKINGHAM AD 911 TO 2018 FROM THE SAXONS TO TODAY

BUCKINGHAM: Saturday 3rd November 2018 at 2.30pm. Admission free
Speaker: David Green, former archaeologist with Buckinghamshire County Council

Our understanding of the history and development of Buckingham is constantly evolving. David Green, a specialist in the county's landscape and towns, will trace changes in Buckingham from its Anglo-Saxon foundation to the present day.

**At the Radcliffe Centre, Church Street, Buckingham MK18 1BY.
Parking available in the University car park in Hunter Street.**



*12th Century Chantry Chapel
Buckingham*



*Anglo-Saxon Penny
Minted at
Buckingham*



St Rumbold's Well